



Mechanical Accessories

CATALOGUE



ABOUT US

Weihai Huitong Hardware & Machinery Co., Ltd., established in 1999, proudly launched its own brand "WIPRO".

Leveraging a professional team, the company is dedicated to high quality products, excellent service and global sales. Company's extensive range of offerings includes Power Tools, pneumatic tools, Cutting Tools, Air Compressors, Welding Machines, Automotive maintenance Tools, Woodworking Machinery, Metal Working Machine and Accessories.

With exceptional product quality, innovative design, and the strong brand philosophy, "WIPRO" products have found their way into countless households, enhancing the quality of life.

The company remains steadfast in upholding the principles of sincerity, cooperation, respect, professionalism, and user-centric experience. "WIPRO" aims to deliver an impeccable one-stop service, offering solutions for various work needs and making life more enjoyable.



CONTENT

Drill Chuck 4
1) Key Type Drill Chuck Light Duty 4
2) Key Type Drill Chuck Medium Duty 5
3) Self-tighten Drill Chuck 6
4) Keyless Chuck 7
5) Key 8
Drill Chuck Arbors 9
Sleeve 10
Live Center 11
J7316b Collects 13

Bench Vice 14
Machine Vice 16
Clamp Holder 20
Chuck 21
Cross Slide Table 23
Rotary Table 24
Collet Index 26
Hardness Tester 27

DRILL CHUCK

Key Type Drill Chuck Light Duty

Application: Recommended for impact electric drills and kinds of AC & DC electric drills.

Features:

1. High precision threaded and tapered tightly mounts on the tools.
2. Jaws are specifically engineered for tight tolerance production drilling.
3. Super precision and durable.

THREAD MOUNT : UNF METRIC



HK SERIES

Code	Model	Capacity		Mount	D (mm)	L1 (mm)	L (mm)	Precision
		mm	Inch					
92756	J3106L	0.6-6	1/64-1/4	3/8-24UNF	30±0.5	40±0.5	50±1	0.35
64228	J3510	1.0-10	1/16-3/8	3/8-24UNF	33.5±0.5	49.5	59.5	0.35
60900	J3510A	1.0-10	1/16-3/8	1/2-20UNF	33.5±0.5	49.5	59.5	0.35
103304	J3510L	1.5-10	1/16-3/8	M10X1.0	33.5±0.5	49.5	59.5	0.35
103504	J3510L	1.5-10	1/16-3/8	M12X1.25	33.5±0.5	49.5	59.5	0.35
104004	J3513L	1.5-13	1/16-1/2	3/8-24UNF	42	57	70.5	0.35
60901	J3513A	1.0-13	1/16-1/2	1/2-20UNF	42	57	70.5	0.35
104404	J3513L	1.5-13	1/16-1/2	M12X1.0	42	57	70.5	0.35
104504	J3513L	1.5-13	1/16-1/2	M12X1.25	42	57	70.5	0.35
104604	J3513L	1.5-13	1/16-1/2	M14X1.0	42	57	70.5	0.35
105004	J3116L	3.0-16	1/8-5/8	3/8-24UNF	51	69	87	0.35
105104	J3116L	3.0-16	1/8-5/8	1/2-20UNF	51	69	87	0.35
105204	J3116L	3.0-16	1/8-5/8	5/8-16UNF	51	69	87	0.35
105504	J3116L	3.0-16	1/8-5/8	M12X1.25	51	69	87	0.35

MORSE TAPER MOUNT

Code	Model	Capacity		Mount	D (mm)	L1 (mm)	L (mm)	Precision
		mm	Inch					
92761	J2106L	0.6-6	1/64-1/4	B10	30	40	50	0.35
92757	J2510	1.5-10	1/16-3/8	B12	33.5	49	59	0.35
92758	J2513L	1.5-13	1/32-1/2	B16	42	57	70	0.35
92759	J2516L	3.0-16	1/8-5/8	B16	51	69	87	0.35
92760	J2516L	3.0-16	1/8-5/8	B18	51	69	87	0.35

JACQUARD TAPER MOUNT

Code	Model	Capacity		Mount	D (mm)	L1 (mm)	L (mm)	Precision
		mm	Inch					
182104	J2606L	0.6-6	1/64-1/4	JT1	30	40	50	0.35
183204	J2610L	1.5-10	1/16-3/8	JT2	33.5	49	59	0.35
184404	J2613L	1.5-13	1/32-1/2	JT33	42	57	70	0.35

KEYTYPE CHUCK

Code	Model	Capacity		Mount	D (mm)	L1 (mm)	L (mm)	Precision
		mm	Inch					
103140	J3510Y	1.5-10	1/64-3/8	1/2-20UNF	39	49	59.6	0.35
103040	J3510Y	1.5-10	1/16-3/8	3/8-24UNF	39	49	59.6	0.35
104040	J3513Y	1.5-13	1/16-1/2	3/8-24UNF	43	62	75	0.35
104140	J3513Y	1.5-13	1/16-1/2	1/2-20UNF	43	62	75	0.35

Key Type Drill Chuck Light Duty



BK SERIES

Application: Recommended for impact electric drills and kinds of AC & DC electric drills.

Features:

1. High precision threaded and tapered tightly mounts on the tools.
2. Jaws are specifically engineered for tight tolerance production drilling.
3. Super precision and durable.

THREAD MOUNT : UNF METRIC

Code	Model	Capacity		Mount	D (mm)	L1 (mm)	L (mm)	Precision
		mm	Inch					
102002	J3506L	0.6-6	1/64-1/4	3/8-24UNF	30	40	50	0.35
103002	J3510L	1.5-10	1/16-3/8	3/8-24UNF	33.5	49.5	59.5	0.35
103102	J3510L	1.5-10	1/16-3/8	1/2-20UNF	33.5	49.5	59.5	0.35
103302	J3510L	1.5-10	1/16-3/8	M10x1.0	33.5	49.5	59.5	0.35
103502	J3510L	1.5-10	1/16-3/8	M12x1.25	33.5	49.5	59.5	0.35

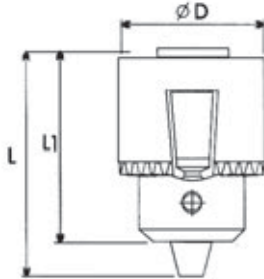

THREAD MOUNT : UNF METRIC

Code	Model	Capacity		Mount	D (mm)	L1 (mm)	L (mm)	Precision
		mm	Inch					
104002	J3513L	1.5-13	1/16-1/2	3/8-24UNF	41.5	57	70.5	0.35
104102	J3513L	1.5-13	1/16-1/2	1/2-20UNF	41.5	57	70.5	0.35
104402	J3513L	1.5-13	1/16-1/2	M12x1.0	41.5	57	70.5	0.35
104502	J3513L	1.5-13	1/16-1/2	M12x1.25	41.5	57	70.5	0.35
104602	J3513L	1.5-13	1/16-1/2	M14x1.0	41.5	57	70.5	0.35
105002	J3516L	3.0-16	1/8-5/8	3/8-24UNF	51	69	87	0.35
64843	J3516	3.0-16	1/8-5/8	1/2-20UNF	51	69	87	0.35
105202	J3516L	3.0-16	1/8-5/8	5/8-16UNF	51	69	87	0.35
105502	J3516L	3.0-16	1/8-5/8	M12x1.25	51	69	87	0.35

MORSE TAPER MOUNT

Code	Model	Capacity		Mount	D (mm)	L1 (mm)	L (mm)	Precision
		mm	Inch					
142002	J2506L	0.6-6	1/64-1/4	B10	30	40	50	0.35
143102	J2510L	1.5-10	1/16-3/8	B12	33.5	49	59	0.35
144202	J2513L	1.5-13	1/16-1/2	B16	42	57	72	0.35
145202	J2516L	3.0-16	1/8-5/8	B16	51	69	87	0.35
145302	J2516L	3.0-16	1/8-5/8	B18	51	69	87	0.35

JACQUARD TAPER MOUNT

Code	Model	Capacity		Mount	D (mm)	L1 (mm)	L (mm)	Precision
		mm	Inch					
182102	J2606L	0.6-6	1/64-1/4	JT1	30	40	50	0.35
183202	J2610L	1.5-10	1/16-3/8	JT2	33.5	49	59	0.35
184402	J2613L	1.5-13	1/16-1/2	JT33	42	57	70	0.35

Key Type Drill Chuck Medium Duty



TYPE A



TYPE B



Cold Pressing

KS SERIES

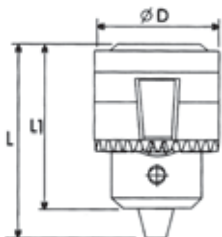

Application: Recommended for Light Medium and Heavy-Duty Portable bench or floor mounted power tools.

Features:

1. High precision threaded and tapered tightly mounts on the tools.
2. Sleeve, key hole and key are shaped by quenching.
3. Jaws are specifically engineered for tight tolerance production drilling.
4. Sleeve teeth and key holes are shaped by cold pressing.
5. Super precision and durable.

THREAD MOUNT : UNF

Code	Model	Capacity		Mount	D (mm)	L1 (mm)	L (mm)	Precision
		mm	Inch					
202000	J3106H	0.6-6	1/64-1/4	3/8-24UNF	30.3	41.7	50.5	0.18
203000	J3110M	1.0-10	1/32-3/8	3/8-24UNF	37	51	60.5	0.25
203100	J3110M	1.0-10	1/32-3/8	1/2-20UNF	37	51	60.5	0.25
204000	J3113M	1.0-13	1/32-1/2	3/8-24UNF	46	64	78	0.25
205000	J3113H	1.0-13	1/32-1/2	5/8-16UN	53	69.5	87	0.18
206200	J3116H	1.0-16	1/32-5/8	5/8-16UN	57	77.5	95	0.18

MORSE TAPER MOUNT

Code	Model	Capacity		Mount	D (mm)	L1 (mm)	L (mm)	Precision
		mm	Inch					
242000	J2106H	0.6-6	1/64-1/4	B10	30.3	40	49	0.18
243100	J2310M	1.0-10	1/32-3/8	B12	37	51	60	0.25
244200	J2313M	1.0-13	1/32-1/2	B16	46±0.5	64	79	0.25
245300	J2113H	1.0-13	1/32-1/2	B16	53	69.5	87	0.18
246300	J2116H	1.0-16	1/32-5/8	B18	53	74	93	0.18

JACQUARD TAPER MOUNT

Code	Model	Capacity		Mount	D (mm)	L1 (mm)	L (mm)	Precision
		mm	Inch					
282100	J2106H	0.6-6	1/64-1/4	JT1	30.3	41.7	50.5	0.18
284400	J2110M	1.0-10	1/32-3/8	JT33	37	51	60.5	0.25
284700	J2113M	1.0-13	1/32-1/2	JT6	46	64	78	0.25
286400	J2116H	1.0-16	1/32-5/8	JT33	57	77.5	95	0.18
287500	J2119H	1.0-19	1/32-3/4	JT4	68	97	120	0.18
287600	J2113H	1.0-13	1/32-1/2	JT6	53	69.5	87	0.18

Key Type Drill Chuck Medium Duty

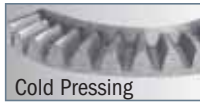

JJ SERIES

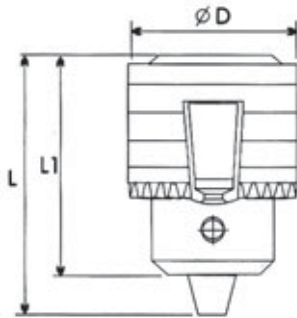

THREAD MOUNT : UNF

Code	Model	Capacity		Mount	D (mm)	L1 (mm)	L (mm)	Precision
		mm	Inch					
303004	J3110H	1.0-10	1/32-3/8	3/8-24UNF	43	53	69	0.25
303104	J3110H	1.0-10	1-32-3/8	1/2-20UNF	43	53	69	0.25
304104	J3113H	1.0-13	1/32-1/2	1/2-20UNF	53	69.5	87	0.25

MORSE TAPER MOUNT

Code	Model	Capacity		Mount	D (mm)	L1 (mm)	L (mm)	Precision
		mm	Inch					
343104	J2110H	1.0-10	1/32-3/8	B12	43	53	69	0.18
92762	J2113H	1.0-13	1/32-1/2	B16	53	69.5	87	0.18
345204	J2516M	3.0-16	1/8-5/8	B16	53	69.5	87	0.25
345304	J2516M	3.0-16	1/8-5/8	B18	53	69.5	87	0.25
92763	J2116H	1.0-16	1/32-5/8	B16	57	77.5	95	0.18
346304	J2116H	1.0-16	1/32-5/8	B18	57	77.5	95	0.18
92764	J2120H	5.0-20	3/16-3/4	B22	65	84	106	0.18
343154	J2106H	0.6-6	1/32-1/4	B10	31	41.7	50	0.18

JACQUARD TAPER MOUNT

Code	Model	Capacity		Mount	D (mm)	L1 (mm)	L (mm)	Precision
		mm	Inch					
383204	J2210H	1.0-10	1/32-3/8	JT2	43	53	69	0.18
384404	J2213H	1.0-13	1/32-1/2	JT33	53	69.5	87	0.18
384704	J2213H	1.0-13	1/32-1/2	JT6	53	69.5	87	0.18
385304	J2616M	3.0-16	1/8-5/8	JT3	53	67.5	87	0.25
385404	J2616M	3.0-16	1/8-5/8	JT33	53	69.5	87	0.25
385704	J2616M	3.0-16	1/8-5/8	JT6	53	69.5	87	0.25
386304	J2216H	1.0-16	1/32-5/8	JT3	57	77.5	95	0.18
388304	J2220H	5.0-20	3/16-3/4	JT3	65	84	106	0.18
383254	J2106H	0.6-6	1/32-1/4	JT1	31	41.7	50	0.18

Key Type Drill Chuck Medium Duty

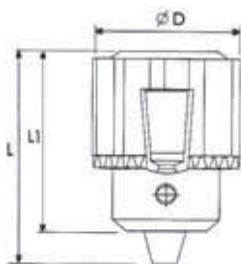
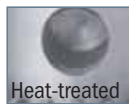

ZW SERIES

MORSE TAPER MOUNT

Code	Model	Capacity		Mount	D (mm)	L1 (mm)	L (mm)	Precision
		mm	Inch					
342002	J2106H	0.6-6	1/64-1/4	B10	31.5	42	50	0.18
343102	J2110H	1.0-10	1/32-3/8	B12	43	53	69	0.18
344202	J2113H	1.0-13	1/32-1/2	B16	53	69±0.5	87	0.18
345202	J2516M	3.0-16	1/8-5/8	B16	53	69	87	0.18
345302	J2516M	3.0-16	1/8-5/8	B18	53	69	87	0.18
346202	J2116H	1.0-16	1/32-5/8	B16	57	77.5	95	0.18
346302	J2116H	1.0-16	1/32-5/8	B18	57	77.5	95	0.18
348402	J2120H	5.0-20	3/16-3/4	B22	65	84	106	0.18

JACQUARD TAPER MOUNT

Code	Model	Capacity		Mount	D (mm)	L1 (mm)	L (mm)	Precision
		mm	Inch					
382102	J2106H	0.6-6	1/64-1/4	JT1	31.5	42	50	0.18
383202	J2110H	1.0-10	1/32-3/8	JT2	43	53	69	0.18
384402	J2113H	1.0-13	1/32-1/2	JT33	53	69.5	87	0.18
384702	J2113H	1.0-13	1/32-1/2	JT6	53	69.5	87	0.18
385302	J2116M	3.0-16	1/8-5/8	JT3	53	69.5	87	0.18
385402	J2116M	3.0-16	1/8-5/8	JT33	53	69.5	87	0.18
385702	J2116M	3.0-16	1/8-5/8	JT6	53	69.5	87	0.18
386302	J2116H	1.0-16	1/32-5/8	JT3	57	77.5	95	0.18
387502	J2119H	1.0-19	1/32-3/4	JT4	68	97	120	0.18
388302	J2120H	5.0-20	3/16-3/4	JT3	65	84	106	0.18

Self-Tighten Drill Chuck

Application: Recommended for CNC machining center.

Features:

1. High precision, and high gripping force, high reliability and stability.
2. Flimsy parts are shaped by quenching.
3. Self-tightening feature automatically increase gripping force proportional to increased torque to prevent tool shank slipping.

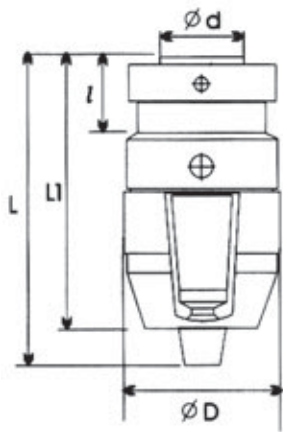

Self-Tighten Drill Chuck (Light Duty)

J01 02 SERIES MORSE.JACQUARD SHORT TAPER STOCK

Code	Model	Capacity (mm)	Tapering Hole Number	Taper	d (mm)	l (mm)	D (mm)	L (mm)	L1 (mm)	KG	Check Rod(mm)		Precision	N.M
											Big Rod	Smal Rodl		
820001	J0106L	0.5-6	B10	2°51'26.7"	10.094	14.500								
821101	J0206L	1/64"-1/4"	JT1	4°24'53.1"	9.754	16.669	34	71.2	61.4	0.32	6x65	-	0.2	3
814201	J0108L	0.5-8	B12	2°51'26.7"	12.065	18.500	36.3	77	69	0.32	8x80	-		4
833201	J0208L	1/64"-5/16"	JT2	4°40'11.6"	14.199	22.225								6
804201	J0110L	1-10	B12	2°51'26.7"	12.065	18.500	44	94.5	84.5	0.96	13x105	6x65	0.2	6
823201	J0210L	1/32"-3/8"	JT2	4°40'11.6"	14.199	22.225								12
806301	J0113L	1-13	B16	2°51'41.0"	15.733	24.000	51	106	92.5	1.24	16x110	8x80	0.2	14
825401	J0213L	1/32"-1/2"	JT33	3°38'13.4"	15.850	25.400								16
808301	J0116L	1-16	B18	2°51'41.0"	17.780	32.000	59	129.2	116	1.70	20x120	10x95	0.2	14
827701	J0216L	1/32"-5/8"	JT6	2°58'24.8"	17.170	25.400								16
810401	J0120L	5-20	B22	2°52'31.5"	21.793	40.500							0.2	16
829301	J0220L	3/16"-3/4"	JT3	3°3'3"	20.599	30.956								

Self-Tighten Drill Chuck (Heavy Duty)

J01 02 SERIES MORSE.JACQUARD SHORT TAPER STOCK

Code	Model	Capacity (mm)	Tapering Hole Number	Taper	d (mm)	l (mm)	D (mm)	L (mm)	L1 (mm)	KG	Check Rod(mm)		Precision		N.M
											Big Rod	Smal Rodl	M	P	
701001	J0106H	0.5-6	B10	2°51'26.7"	10.094	14.500									
720101	J0206H	1/64"-1/4"	JT1	4°24'53.1"	9.754	16.669	34	73.5	64.5	0.32	6 x 65	-	0.05	0.08	3
713101	J0108H	0.5-8	B12	2°51'26.7"	12.065	18.500	34	71	64.5	0.50	8 x 80	-	0.05	0.10	4
732201	J0208H	1/64"-5/16"	JT2	4°40'11.6"	14.199	22.225									
707101	J0110H	1-10	B12	2°51'26.7"	12.065	18.500	44	93	81.2	0.70	10 x 95	6 x 65	0.05	0.10	6
722201	J0210H	1/32"-3/8"	JT2	4°40'11.6"	14.199	22.225									
705201	J0113H	1-13	B16	2°51'41.0"	15.733	24.000	51	105	94	0.96	13 x 105	6 x 65	0.05	0.10	12
724101	J0213H	1/32"-1/2"	JT33	3°38'13.4"	15.850	25.400									
707301	J0116H	1-16	B18	2°51'41.0"	17.780	32.000	54	115.5	104	1.24	16 x 110	8 x 80	0.05	0.10	14
726701	J0216H	1/32"-5/8"	JT6	2°58'24.8"	17.170	25.400									
709401	J0120H	5-20	B22	2°52'31.5"	21.793	40.500	57	129.2	115	1.70	20 x 120	10 x 95	0.05	0.10	16
728301	J0220H	3/16"-3/4"	JT3	3°3'3"	20.599	30.956									

Keyless Chuck



J1510A TYPE A

J1510JY TYPE A

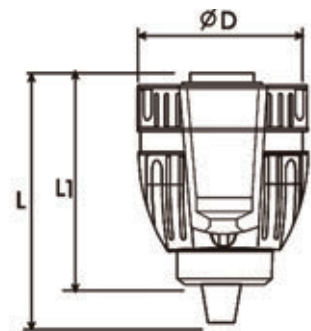

Code	Model	Capacity		Mount	D (mm)	L1 (mm)	L (mm)	Precision
		mm	Inch					
92765	KBL-10	1-10	1/32-3/8	3/8-24UNF	41	51±0.5	59±1	0.35
002130	J1510A	1-10	1/32-3/8	1/2-20UNF	43	51±0.6	59±1	0.35
003001	J1513A	2-13	1/16-1/2	3/8-24UNF	43	62	75	0.35
92766	KBL-13	2-13	1/16-1/2	1/2-20UNF	43	62	75	0.35
002009	J1510JY	0.8-10	1/32-3/8	3/8-24UNF	41	51±0.5	61	0.35
002109	J1510JY	0.8-10	1/32-1/8	1/2-20UNF	41	51±0.6	61	0.35
003009	J1513JY	1.5-13	1/16-1/2	3/8-24UNF	43	62	75	0.35
003109	J1513JY	1.5-13	1/16-1/2	1/2-20UNF	43	62	75	0.35

Keyless Chuck with Lock System

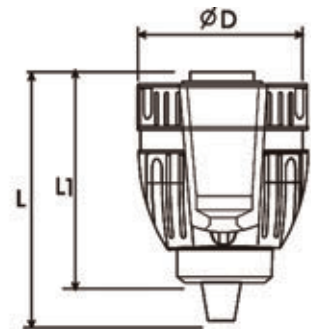

Code	Model	Capacity		Mount	D (mm)	L1 (mm)	L (mm)	Precision
		mm	Inch					
005004	J9713D	1.5-13	1/16-1/2	3/8-24UNF	43	62	75	0.35
005104	J9713D	1.5-13	1/16-1/2	1/2-20UNF	43	62	75	0.35

Key



Type A



Type B



Type C



Type D

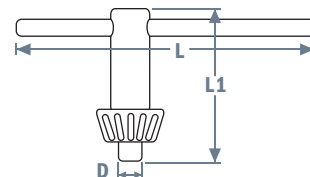

TYPE	D (mm)	L1 (mm)	L (mm)	Weight(g)	Suitable Chuck
A	6	31.5	56	25	6mm Light 10mm Light
	6	39	80	45	13mm Light 10mm Heavy
	6	45	110	60	16mm
B	3	32	60	15	4mm
	5	30	56	25	6mm Heavy
	6	32	56	25	6mm Light 10mm Light
C	6	39	80	45	13mm Light 10mm Heavy
	6	32	60	25	10mm 13mm
D	6	45	82	120	13mm Light
	8	44	85	125	16mm
	9	60	125	185	19mm 20mm

CENTER

Super Rolling Center

Center is assembled with needle bearing thrust bearing & ball bearing.

Applicable to CNC lathes. Can be used at high speed turning and for medium and heavy duty.

The shaft is made of alloy steel and through heat treatment(HRC $60^{\circ}\pm 2^{\circ}$) it processes high rigidity and high durability.

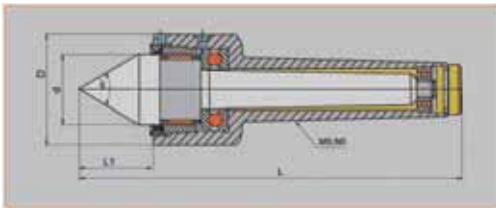

Code	Model	D (mm)	d (mm)	L (mm)	L1 (mm)	Max Load (N)	Max Speed (rpm)	Accuracy (mm)
003080	MT2	36	22	125	25.5	340	6000	0.005
003081	MT3	47	30	162	32	400	5000	0.005
003082	MT4	55	35	194	37.5	1300	3500	0.005
003083	MT5	70	45	240	47	2000	3500	0.005
003084	MT6	90	60	318	62	4000	6000	0.005

Super Rolling Center

Center is assembled with needle bearing thrust bearing & ball bearing.

Applicable to CNC lathes. Can be used at high speed turning and for medium and heavy duty.

The shaft is made of alloy steel and through heat treatment(HRC $60^{\circ}\pm 2^{\circ}$) it processes high rigidity and high durability.

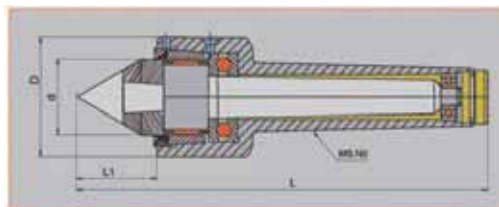

Code	Model	D (mm)	d (mm)	L (mm)	L1 (mm)	Max Load (N)	Max Speed (rpm)	Accuracy (mm)
003085	MT2	36	22	125	25.5	340	6000	0.005
003086	MT3	47	30	162	32	400	5000	0.005
003087	MT4	55	35	194	37.5	1300	3500	0.005
003088	MT5	70	45	240	47	2000	3500	0.005
003089	MT6	90	60	318	62	4000	6000	0.005

Medium-Duty Live Center

Center is assembled with bearing and plane thrust bearing.

Can be used at medium speed.

The shaft is made of alloy steel and through heat treatment HRC $60^{\circ}\pm 2^{\circ}$, it processes super steel trait and high durability.

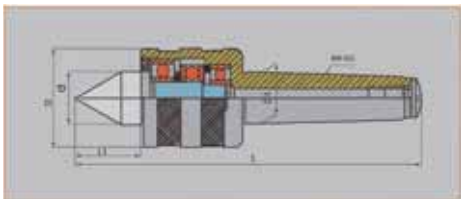

Code	Model	L (mm)	D (mm)	L1 (mm)	d (mm)	d (mm)	Max Load (N)	Max Speed (rmp)	Accuracy (mm)
003090	D411	115	34	20	18	12.065	900	5000	0.01
003091	D412	145	45	26	25	17.780	1500	5000	0.01
003092	D413	170	52	30	28	23.825	2000	4200	0.01
003093	D414	205.7	60	34.7	32	31.267	3200	3200	0.01
003094	D415	254	77	45	45	44.399	3600	1000	0.015
003095	D416	362	125	68.5	75	63.348	10000	800	0.015

Super High-Speed Water-Proof Type

The thimble located berrel ball bearing.

Suitable for CNC machine, high speed and light duty, waterproof and dustproof design.

The mandrel adopt alloy steel and heat treatment(HRC $60^{\circ}\pm 2^{\circ}$), Super steel trait and durability.

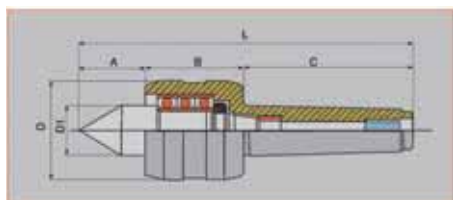

Code	Model	A (mm)	B (mm)	C (mm)	D (mm)	D1 (mm)	L (mm)	Max Speed (rmp)	Accuracy (mm)
003055	MT3	38	58	86	48	30	182	10000	0.005
003056	MT4	45	65	108	62	32	215	10000	0.005
003057	MT5	50	70	136	72	40	256	8000	0.005

Medium-Load-Type

Medium-Load-Center

Center is assembled with ball bearing and precision angular contact ball bearing.

Applicable to CNC lathes. Can be used at high speed turning.

The shaft is made of alloy steel and through heat treatment (HRC $60^{\circ}\pm 2^{\circ}$), it processes high rigidity and high durability.

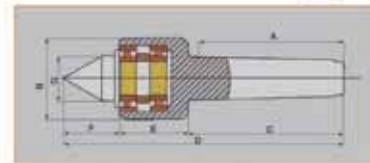

Code	Model	Size	A (mm)	B (mm)	C (mm)	D (mm)	E (mm)	F (mm)	G (mm)	Max Speed (rpm)	Accuracy (mm)
92767	LC-1	MT1	54	38	59	118	34	25	19	4000	0.005
92768	LC-2	MT2	65	38	71	131	34	25	19	4000	0.005
92769	LC-3	MT3	81	41	87	134	35	29	22	4000	0.005
92770	LC-4	MT4	103	57	113	197	51	33	29	4000	0.005
92771	LC-5	MT5	132	64	141	238	57	40	32	3500	0.005
92772	LC-6	MT6	184	89	194	330	83	54	44	3000	0.005

Normal Type

The center is assembled with ball bearing.

Suitable for middle/high speed and light duty.

The shaft adopt alloy steel and heat treatment (HRC $60^{\circ}\pm 2^{\circ}$), Super steel trait and durable.

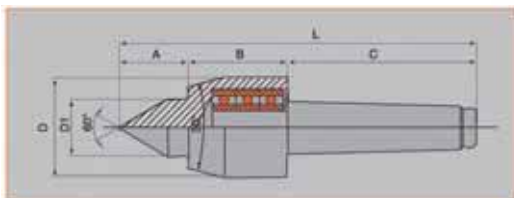

TYPE A



TYPE B

Code	Model	A (mm)	B (mm)	C (mm)	D (mm)	D1 (mm)	L (mm)	Max Speed (rpm)	Accuracy (mm)
003070	MT1	21	31	56	32	16	106	4000	0.005
003071	MT2	26	37	69	40	22	132	4000	0.005
003072	MT3	32	46	86	45	26	164	4000	0.005
003073	MT4	34	46	108	48	30	188	4000	0.005
003074	MT5	50	62	136	68	45	248	3500	0.005

Carbide Half-Notched Center

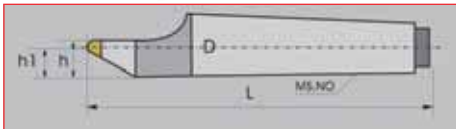

Code	Model	MS.NO	D (mm)	L (mm)	Weight (kg)	Accuracy (mm)
003007	D142	2	17.78	100	0.15	0.010
003008	D143	3	23.825	125	0.34	0.010
003009	D144	4	31.267	160	0.71	0.010
003010	D145	5	44.399	200	1.78	0.010
003011	D146	6	63.348	280	5.0	0.010

Half-Notched Center

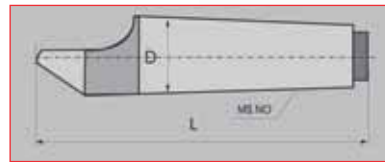

Code	Model	MS.NO	D (mm)	L (mm)	Weight (kg)	Accuracy (mm)
003001	D121	1	12.065	80	0.054	0.010
003002	D122	2	17.78	100	0.143	0.010
003003	D123	3	23.825	125	0.323	0.010
003004	D124	4	31.267	160	0.703	0.010
003005	D125	5	44.399	200	1.862	0.010
003006	D126	6	63.348	280	4.925	0.010

Dead Center



Code	Model	MS.NO	D (mm)	L (mm)	Weight (kg)	Accuracy (mm)
003012	D111	1	12.065	80	0.057	0.010
003013	D112	2	17.78	100	0.150	0.010
003014	D113	3	23.825	125	0.334	0.010
003015	D114	4	31.267	160	0.746	0.010
003016	D115	5	44.399	200	1.862	0.010
003017	D116	6	63.348	280	4.925	0.010

Carbide Center



Code	Model	MS.NO	D (mm)	L (mm)	Weight (kg)	Accuracy (mm)
92773	DC-2	2	17.78	100	0.151	0.010
92774	DC-3	3	23.825	125	0.335	0.010
92775	DC-4	4	31.267	160	0.746	0.010
92776	DC-5	5	44.399	200	1.826	0.010
92777	DC-6	6	63.348	280	5.23	0.010

SLEEVE

Morse Taper Drill Chuck Arbors With Tang

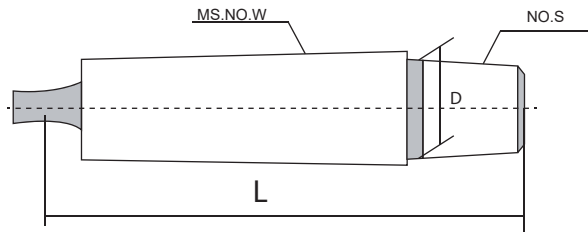

Code	Model	MS.NO.W	NO.S	D	L
				(mm)	(mm)
92778	AB-110	MS1	B10	10.094	84
92779	AB-112	MS1	B12	12.065	88
92780	AB-116	MS1	B16	15.733	94
92781	AB-118	MS1	B18	17.78	100
92782	AB-210	MS2	B10	10.091	97
92783	AB-212	MS2	B12	12.065	101
92784	AB-216	MS2	B16	15.733	107
92785	AB-218	MS2	B18	17.78	115
92786	AB-222	MS2	B22	21.793	124
92787	AB-310	MS3	B10	10.094	116
92788	AB-312	MS3	B12	12.065	120
92789	AB-316	MS3	B16	15.733	126
92790	AB-318	MS3	B18	17.78	134
92791	AB-322	MS3	B22	21.793	143
92792	AB-418	MS4	B18	12.065	159
92793	AB-422	MS4	B22	15.733	167
92794	AB-516	MS5	B16	15.733	184
92795	AB-518	MS5	B18	17.78	192
92796	AB-522	MS5	B22	21.793	200

Morse Taper Sleeves

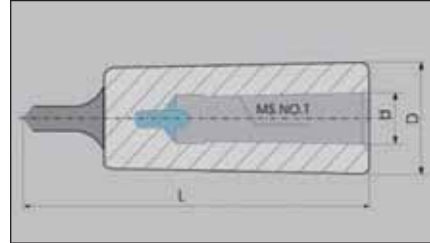

Part No.	Model	MS.NO.S	D	d	L	Weight	Accuracy
			(mm)	(mm)	(mm)	(kg)	(mm)
92797	SB-21	MT2-MT1	18.6	12.065	92	0.1	0.015
92798	SB-31	MT3-MT1	24.1	12.065	99	0.24	0.015
92802	SB-43	MT4-MT3	32.4	23.825	140	0.38	0.02
92804	SB-52	MT5-MT2	44.7	17.78	156	1.49	0.02
92805	SB-53	MT5-MT3	44.7	23.825	156	1.36	0.02
92806	SB-54	MT5-MT4	45.5	3.267	171	0.95	0.02
92808	SB-62	MT6-MT2	63.8	17.78	218	3.73	0.02
92809	SB-63	MT6-MT3	63.8	23.825	218	3.85	0.02
92810	SB-64	MT6-MT4	63.8	31.267	218	3.12	0.02
92811	SB-65	MT6-MT5	63.8	44.399	218	1.95	0.02

J7316B COLLECTS

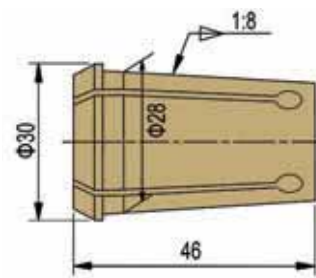

Code:00-0000

Model	Ps/set	Hole size		Shank	Weight(kg)
		mm	Inch		
J7316B/R8	8	4.5.6.8.10. 12.14.16	1/8, 3/16,1/4, 5/16,3/8, 1/2,9/16, 5/8	R8	3.580
J7316B/30				IS030	3.373
J7316B/40				IS040	3.708
J7316B/50				IS050	5.110
J7316B/MT2				MT2	3.520
J7316B/MT3				MT3	3.752
J7316B/MT4				MT4	4.646
J7316B/MT5				MT5	3.430
J7316B/1"				1"	3.800
J7316B/1- 1/4"				1-1/4"	4.506

BENCH VICE

83 Type with Anvil Swivel Base(Heavy Duty)



Code	Specification (inch)	Width of Jaws (mm)	QTY/case (pcs)	G.W./N.W. (kgs)	Carton Size (cm)
00-0000-000	3"	75	6	39/36	56x42x16
00-0000-000	4"	100	4	48/45	71x35x19
00-0000-000	5"	125	1	21/20	45x20x25
00-0000-000	6"	150	1	33/30	52x22x27
00-0000-000	8"	200	1	51/48	60x25x30
00-0000-000	10"	250	1	70/59	71x33x39

83 Type With Anvil Stationary Base(Heavy Duty)



Code	Specification (inch)	Width of Jaws (mm)	QTY/case (pcs)	G.W./N.W. (kgs)	Carton Size (cm)
00-0000-000	3"	75	6	36/33	56x42x16
60003142	4"	100	4	45/42	71x35x19
00-0000-000	5"	125	1	19/18	45x20x25
60003143	6"	150	1	30/27	52x22x27
71569	8"	200	1	47/44	60x25x30
00-0000-000	10"	250	1	66/55	71x33x36

83 Type Without Anvil Swivel Base(Heavy Duty)



Code	Specification (inch)	Width of Jaws (mm)	QTY/case (pcs)	G.W./N.W. (kgs)	Carton Size (cm)
00-0000-000	3"	75	6	36/33	56x42x16
00-0000-000	4"	100	4	43/40	71x35x19
00-0000-000	5"	125	1	20/19	45x20x25
00-0000-000	6"	150	1	30/27	52x22x27
00-0000-000	8"	200	1	47/44	60x25x30

MACHINE VICE

Q93 Double-Action Angle Tight Machine Vice



Code	Model	Width of jaw (mm)	Height of jaw (mm)	Max.opening (mm)	G.W./N.W. (kg)	Packing volume LxWxH (cm)
00-0000-000	Q93100	100	35	76	19/17	58x18x16.5
00-0000-000	Q93160	160	50	100	54/47	73x28x20

QHK Inclinable Machine Vice



Code	Model	Width of jaw (mm)	Height of jaw (mm)	Max.opening (mm)	G.W./N.W. (kg)	Packing volume LxWxH (cm)
00-0000-000	Q41(QHK)100	100	41	80	19/18	36x22x20
00-0000-000	Q41(QHK)125	125	46	100	29/27.5	46x26x21.5
00-0000-000	Q41(QHK)125L	125	46	140	29/27.5	46x26x21.5
00-0000-000	Q41(QHK)160	160	50	125	43/41.5	46.5x29x24.5

QW Universal Machine Vice



Code	Model	Width of jaw (mm)	Height of jaw (mm)	Max.opening (mm)	G.W./N.W. (kg)	Packing volume LxWxH (cm)
00-0000-000	QW100	105	40	105	31/26	51x34x25
00-0000-000	QW125	125	40	125	33/28	56x34x26

Q62V Machine Vice



Code	Model	Width of jaw (mm)	Max.opening (mm)	G.W./N.W. (kg)	Packing volume LxWxH (cm)
00-0000-000	Q62100	100	∅ 10-80	22/21	32x21x23

QM16N Accu-Lock Precision Machine Vice



Code	Model	Width of jaw (mm)	Height of jaw (mm)	Max.opening (mm)	G.W./N.W. (kg)	Packing volume LxWxH (cm)
00-0000-000	QM16160N	160	45	140	36/35	48x20x21

QM16 Accu-Lock Precision Machine Vice



Code	Model	Width of jaw (mm)	Height of jaw (mm)	Max.opening (mm)	G.W./N.W. (kg)	Packing volume LxWxH(cm)	Packing shape
00-0000-000	QM16100	100	32	100	17/16	38x25x18	CARTON
00-0000-000	QM16160	160	45	160	37/36	49x32x23	CARTON
00-0000-000	QM16200	200	50	190	62/56	62.5x41x25.5	WOODEN CASE

Accu-Lock Precision Machine Vice

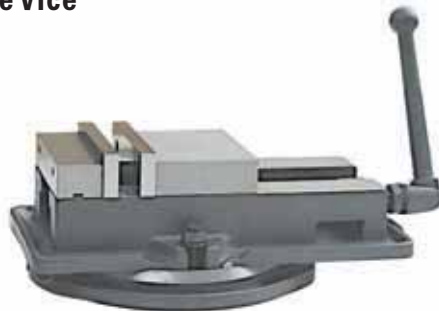

Code	Model	Width of jaw (mm)	Height of jaw (mm)	Max.opening (mm)	G.W./N.W. (kg)	Packing volume LxWxH(cm)	Packing shape
00-0000-000	QM16160A	160	45	190	51/49	50.5x30x20	CARTON

QK-D Can Slopeing Type Drilling Machine Jig Inclinable Machine Clamp



Code	Model	Width of jaw (mm)	Height of jaw (mm)	Max.opening (mm)	G.W./N.W. (kg)	Packing volume LxWxH(cm)	Packing shape
00-0000-000	QK4D	106	46	95	8.5/8	26x21x14	CARTON
00-0000-000	QK3 1/4	85	32	80	20/18 4pcs/case	51x30x13	CARTON
00-0000-000	QK3 1/4	115	38	90	27/25 4pcs/case	58x35x14	CARTON

83 Type With Anvil Swivel Base(Heavy Duty)



Code	Specification (inch)	Width of Jaws (mm)	QTY/ case (pcs)	G.W./N.W. (kgs)	Carton Size (cm)
00-0000-000	3"	75	6	33/30	56x42x16
00-0000-000	4"	100	4	40/37	71x35x19
00-0000-000	5"	125	1	18/17	45x20x25
00-0000-000	6"	150	1	27/24	52x22x27
00-0000-000	8"	200	1	43/40	60x25x30

Series Of Multifunction Clamp



Code	Specification	Width of jaw (mm)	Height of jaw (mm)	Max.opening (mm)	Lengthwise stroke	Crosswise stroke	G.W./N.W. (kg)	Packing volume LxWxH(cm)	Packing shape
00-0000-000	Q97-80	80	30	65	70mm	65mm	6.5/6	24x24x14	CARTON
00-0000-000	Q97-100	102	35	90	80mm	80mm	10.3/9.5	27x27x16	CARTON
00-0000-000	Q97-125	125	41	115	95mm	95mm	14.2/13.5	29x29x17	CARTON
00-0000-000	Q97-150	152	42	135	100mm	100mm	17.7/16.7	32x32x18	CARTON
00-0000-000	Q97-200	203	47	165	130mm	130mm	26.3/25	38.5x38.5x19	CARTON

Series Of Multifunction Clamp



Code	Specification	Width of jaw (mm)	Max.opening (mm)	Cross. Max opening(mm)	G.W./N.W. (kg)	Packing volume LxWxH(cm)	Angle	Packing shape
00-0000-000	Q97100B	102	90	80	12/11.5	27x27x17.5	360°	CARTON
00-0000-000	Q97125B	125	115	95	16.5/16	29x29x18.5	360°	CARTON
00-0000-000	Q97150B	150	135	100	20/19.5	32x32x20.5	360°	CARTON

Table Vice



Code	Model	Width of jaw (mm)	Max.opening (mm)	G.W./N.W. (kg)	Packing volume LxWxH(cm)	Packing shape
00-0000-000	Z50	50	45	30/26 10sets/carton	45x38x23	CARTON
60003145	Z60	60	55	30/26 10sets/carton	45x38x23	CARTON

QH Machine Vice



Code	Model	Width of jaw (mm)	Height of jaw (mm)	Max.opening (mm)	G.W./N.W. (kg)	Packing volume LxWxH(cm)	Packing shape
00-0000-000	Q12(QH)80	80	30	65	38/28 4sets/carton	48x29x13	CARTON
00-0000-000	Q12(QH)100	100	35	80	40/28 4sets/carton	56x26x21.5	CARTON
00-0000-000	Q12(QH)125	125	40	100	17/16	33x19x17	CARTON
00-0000-000	Q12(QH)160	160	52	125	38/36	45x25x23.5	CARTON
00-0000-000	Q12(QH)200	200	63	160	54/52	48x27x24.5	CARTON

QB Machine Vice



Code	Model	Width of jaw (mm)	Height of jaw (mm)	Max.opening (mm)	G.W./N.W. (kg)	Packing volume LxWxH(cm)	Packing shape
00-0000-000	Q13(QB)136	136	36	170	18/17	43x20x22	CARTON
00-0000-000	Q13(QB)160	160	51	180	24/23	43x20x22	CARTON
00-0000-000	Q13(QB)200	200	64	280	43/41	50x25x23	CARTON
00-0000-000	Q13(QB)250	250	64	280	69/67	61x33x27	CARTON
00-0000-000	Q13(QB)320	320	81	360	94/88	78x45x29.5	CARTON

TOGGLE CLAMP

TOGGLE CLAMP VERTICAL STYLE



TCV-904



TCV-905

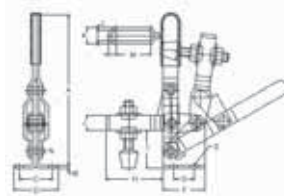

U-BAR, FLANGED BASE, STRAIGHT HANDLE
HANDLE MOVES 60° BAR 100°

Model	Code	Spec.	Capacity	Size(mm)							
				A	B	C	D	E	F	G	H
TCV-904	86742	101D	180kg	171	3	30	43	4-6X7.5	39	19	49
				I	J	K	L	M	N		
				28.5	14	16	9.5	36.5	12.3		
TCV-905	86743	101E	180kg	A	B	C	D	E	F	G	H
				171	3	30	43	4-6X7.5	39	19	98
				I	J	K	L	M	N		
				28.5	14	16	9.5	85	12.3		



TCV-906

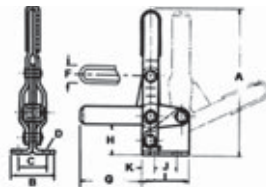

TOGGLE CLAMP VERTICAL STYLE

U-BAR, FLANGED BASE, STRAIGHT HANDLE
HANDLE MOVES 65° BAR 90°

Model	Code	Spec.	Capacity	Size(mm)							
				A	B	C	D	F	G	H	I
TCV-906	86744	102B	100kg	101	28	18	4-Φ5	11.5	37	11.5	29.7
				J	K						
				14	7.9						



TCV-907

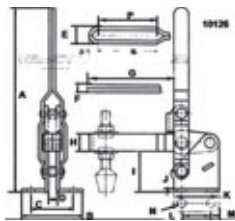

TOGGLE CLAMP VERTICAL STYLE

U-BAR, FLANGED BASE, STRAIGHT HANDLE
HANDLE MOVES 58° BAR 105°

Model	Code	Spec.	Capacity	Size(mm)							
				A	B	C	D	E	F	G	H
TCV-907	86745	10126	340kg	200	64.5	45	9.2	21	4	85	19
				I	J	K	L	M	N	P	
				37	3	50	32	9	4-Φ8	58	



TCH-911

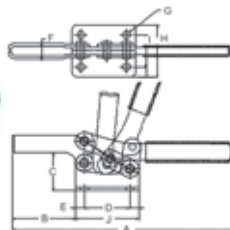

TOGGLE CLAMP HORIZONTAL STYLE

HANDLE MOVES 58° BAR 85°

Model	Code	Spec.	Capacity	Size(mm)							
				A	B	C	D	E	F	G	H
TCH-911	86746	A203F	340kg	200	53	32	41	8	10	4-Φ7	45
				I	J						
				26	57.7						



TCH-921

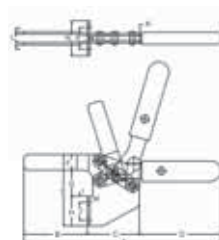

TOGGLE CLAMP HORIZONTAL STYLE

HANDLE OPENS 80°/BAR OPEN 90°

Model	Code	Spec.	Capacity	Size(mm)							
				A	B	C	D	E	F	G	H
TCH-921	86751	25383	280kg	200	17	65	102	89	17	30	42
				I	J	K	L	M	N	P	
				7.5	26.5	6	16	4-6.5X8	45	25	

TOGGLE CLAMP

TOGGLE CLAMP HORIZONTAL STYLE

HANDLE MOVES 85 BAR 84°



TCH-912

SUPPLIDE WITH: GH-FC-38312



TCH-913

SUPPLIDE WITH: GH-FC-38312



TCH-914

SUPPLIDE WITH: GH-FC-38412



TCH-915

SUPPLIDE WITH: GH-FC-38412

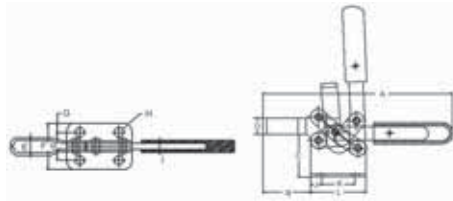

Model	Code	Spec.	Capacity	Size(mm)									
				A	B	C	D	E	F	G	H	I	
TCH-912	86747	200W	400kg	237	61.8	54.3	20.7	18.2	50.2	10.6	10		
				I	J	K	L	M					
				5.87	13.7	42	69.8	28.7					
TCH-913	86748	200WL	400kg	287	110	56	20.7	19.7	50.2	10.4	10		
				I	J	K	L	M					
				5.7	14	42	70	29.5					
TCH-914	86749	220WH	400kg	240	62	76.7	20.7	18.1	50.2	10.9	10		
				I	J	K	L	M					
				6	14	42	70	28.7					
TCH-915	86750	220WLH	400kg	290	109	75	20.7	18.7	50.2	11	10		
				I	J	K	L	M					
				6	14	42	70	28.7					

TOGGLE CLAMP PUSH-PULL STYLE



TCP-931

SUPPLIDE WITH:GH-SA-085012
HANDLE:45°



TCP-932

SUPPLIDE WITH:GH-SA-085012
HANDLE:90°



TCP-933

SUPPLIDE WITH:GH-SA-105015
HANDLE:45°



TCP-934

SUPPLIDE WITH:GH-SA-105015
HANDLE:90°

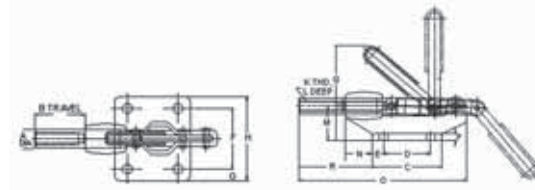

Model	Code	Spec.	Capacity	Size(mm)									
				A	B	C	D	E	F	G	H	I	
TCP-931	86752	304C	227kg	12.9	32	52.6	34.5	8.6	40.6	9	58.5	7	
				K	P	L	M	N	O	P	Q	R	
				M8	1.25	40	25	22.3	126.8	6.7	76	56.5	
TCP-932	86753	305C	227kg	12.9	33.9	52.9	34.5	8.6	40.6	9	58.5	7	
				K	P	L	M	N	O	P	Q	R	
				M8	1.25	40	25	22.3	127	6.7	99.5	56.5	
TCP-933	86754	304E	386kg	15.9	43	59.8	41.2	8.6	41.5	9	59.2	7	
				K	P	L	M	N	O	P	Q	R	
				M10	1.5	40	32	32	158	7.1	107	74	
TCP-934	86755	305E	386kg	15.9	43	59.8	41.2	8.6	41.5	9	59.2	7	
				K	P	L	M	N	O	P	Q	R	
				M10	1.5	40	31.8	31.8	158	7.1	127	74	

TOGGLE CLAMP PUSH-PULL STYLE

SUPPLIDE WITH:GH-SA-105015

PLUNGER TRAVEL:51.8MM. Accepts All M10X1.5 spindles



TCH-935

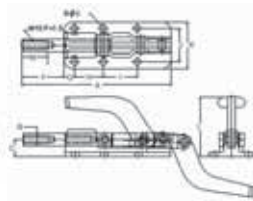

Model	Code	Spec.	Capacity	Size(mm)								
				A	B	C	D	E	F	G	H	
TCH-935	86756	36330	1136kg	200	17	65	102	89	17	30	42	
				I	J	K	L	M	N	P		
				7.5	26.5	6	16	4-6.5X8	45	25		

CLAMP HOLDER

Clamping Kit With Metal Holder



58pcs Clamping Kit With Metal Holder

Code:00-0000-000

NO.	Table T-slot Size (US)	Stud size (mm)	NO.	Table T-slot Size (US)	Stud size (mm)
YT-0101	3/8	5/16-18	YT-0201	9.7	M8 x 1.25
YT-0102	7/16	3/8-16	YT-0202	11.7	M10 x 1.5
YT-0103	1/2	3/8-16	YT-0203	13.7	M10 x 1.5
YT-0104	9/16	3/8-16	YT-0204	13.7	M12 x 1.75
YT-0105	9/16	1/2-13	YT-0205	15.7	M12 x 1.75
YT-0106	5/8	1/2-13	YT-0206	15.7	M14 x 2
YT-0107	11/16	1/2-13	YT-0207	17.7	M14 x 2
YT-0108	11/16	5/8-11	YT-0208	17.7	M16 x 2
YT-0109	3/4	5/8-11	YT-0209	19.7	M16 x 2
YT-0110	13/16	5/8-11	YT-0210	19.7	M18 x 2.5
YT-0111	13/16	3/4-10	YT-0211	21.7	M18 x 2.5
YT-0112	7/8	3/4-10	YT-0212	21.7	M20 x 2.5
YT-0113	1	3/4-10	YT-0213	21.7	M20 x 2.5

58pcs T-NUT & STUD With Wood Holder



Code:00-0000-000

NO.	Table T-slot Size (US)	Stud size (mm)	NO.	Table T-slot Size (US)	Stud size (mm)
YT-0501	3/8	5/16-18	YT-0601	9.7	M8 x 1.25
YT-0502	7/16	3/8-16	YT-0602	11.7	M10 x 1.5
YT-0503	1/2	3/8-16	YT-0603	13.7	M10 x 1.5
YT-0504	9/16	3/8-16	YT-0604	13.7	M12 x 1.75
YT-0505	9/16	1/2-13	YT-0605	15.7	M12 x 1.75
YT-0506	5/8	1/2-13	YT-0606	15.7	M14 x 2
YT-0507	11/16	1/2-13	YT-0607	17.7	M14 x 2
YT-0508	11/16	5/8-11	YT-0608	17.7	M16 x 2
YT-0509	3/4	5/8-11	YT-0609	19.7	M16 x 2
YT-0510	13/16	5/8-11	YT-0610	19.7	M18 x 2.5

CHUCK

K11 Series Three-Jaw Self-Centring Chucks

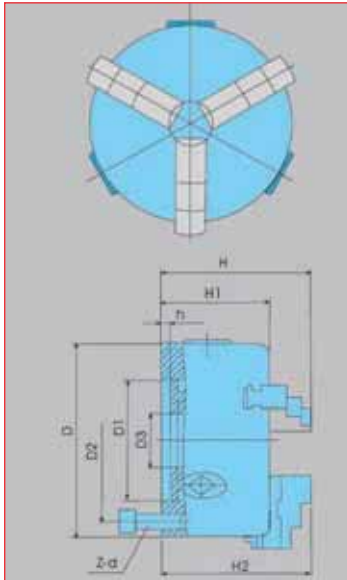

Features:

1. Short cylindrical center mounting.
2. Model K11 chucks are provided with one-piece jaws(which include a set of internal jaws and a set of external jaws).
3. As requested, we can provide chucks mounted from front.

Dimension parameters

Suit: mm

Code	Model	size (D)	D1	D2	D3	H	H1	H2	h	z-d
75818	K11-80	80	55	66	16		50	-	3.5	3-M6
75819	K11-100	100	72	84	22	66	55	-	3.5	3-M8x1.25
75820	K11-125	125	95	108	30	87.5	58	101.5	4	3-M8x1.25
65159	K11-160	160	130	142	40	100	65	113	5	3-M10x1.5
76575	K11-200	200	165	180	65	114	75	125	5	3-M10x1.5
76576	K11-250	250	200	224	76	130	90	143	5	3-M12x1.75
0000	K11-315	315	260	286	103	157	100	157	5	3-M16x2
00-0000-000	K11-400	400	330	382	136	182	110	170	5	3-M16x2
00-0000-000	K11-500	500	420	458	190	206	119	199	5	6-M16x2
00-0000-000	K11-630	630	545	586	252	213.5	129	216	7	6-M16x2
00-0000-000	K11-800	800	710	460	410	240	151		8.5	6-M24x2

K72 Series Four-jaw Independent Chucks

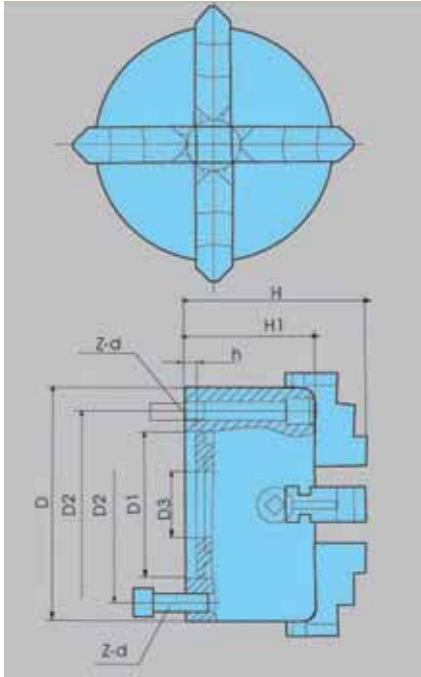

Application:

Recommended for processing of non-ferrous metals, non-metals like plastics and so on.

Features:

1. High precision short cylindrical center mounting.
2. Flimsy parts are specifically engineered by quenching, for greater durability and extended life.
3. Adjusted independently to center, suitable for processing special with superior gripping force.



Dimension parameters

Suit: mm

Code	Model	Size (D)	D1	D2	D3	H	H1	h	z-d	h	Max. Speed
00-0000-000	K72-80	80	62	72	25	57	40	5	1/4-20	4	4000 rpm
00-0000-000	K72-100	100	79.4	54	25	57	40	2.5	1/4-20	4	4000 rpm
00-0000-000	K72-125	125	70	54	26	63	43	2.5	5/16-18	4	3500 rpm
00-0000-000	K72-160	160	82.5	69.8	42	63	43	2.5	3/8-16	4	3200 rpm
65162	K72-200	200	110	82.6	50	120	80	5	7/16-14	4	1800 rpm
65163	K72-250	250	150	104.8	65	125	85	7	1/2-13	4	1500 rpm
65164	K72-300	315	175	133.4	80	145	95	7	5/8-11	4	1200 rpm
65167	K72-400	400	200	171.4	100	155	105	10	5/8-11	4	800 rpm
65168	K72-500	500	270	235	125	179.5	120	12	3/4-10	4	500 rpm
65169	K72-630	630	270	235	160	199.5	140	12	3/4-10	4	400 rpm
00-0000-000	K72-800	800	380	330.2	200	230.8	160	12	7/8-9	4	300 rpm
00-0000-000	K72-900	900	370	330	190	272.8	170	18	1-8	8	150 rpm

Three-JAW Manual Chucks

Features:

1. The chucks have two mounting types: the short cylindrical center mounting and the thread mounting.
2. The compact chucks are small volume, easy to be used and enjoy a high centring precision as well as a large clamping range.
3. The chucks are made for meter machine tools in the processing of non-ferrous metals, non-metals like plastics and so on.
4. Steel body.

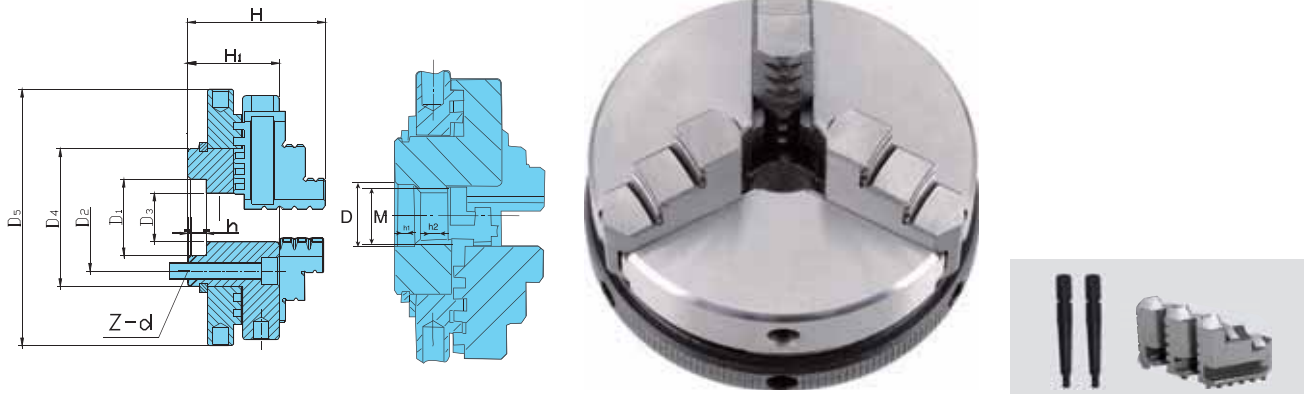

Code	Code	D	D1	D2	D3	D4	D5	H	H1	h	h1	h2	Z-d	M	Clamping Range	Jamming Range	N.W. (kg)
92812	CTB3-150	15			15	30	52	47	33	6	6	12		M14x1	1-33	16-50	
92813	CTB3-163	15	22	28	14	36	68	42	28	6	6	12	3-M4	M14x1	1-50	16-50	0.5
00000	CTB3-180	16.1	25	35	16	45	84	42	30	6	5	9.5	3-M5	M16x1	1.5-70	20-70	1.5
00000	CTB3-200	24.1	32	42	22	52	104	52	36.5	6	5	13.5	3-M6	M24x1.5	2-90	26-90	2

Four-JAW Manual Chucks

Features:

1. The chucks have two mounting types: the short cylindrical center mounting and the thread mounting.
2. The compact chucks are small volume, easy to be used and enjoy a high centring precision as well as a large clamping range.
3. The chucks are made for meter machine tools in the processing of non-ferrous metals, non-metals like plastics and so on.

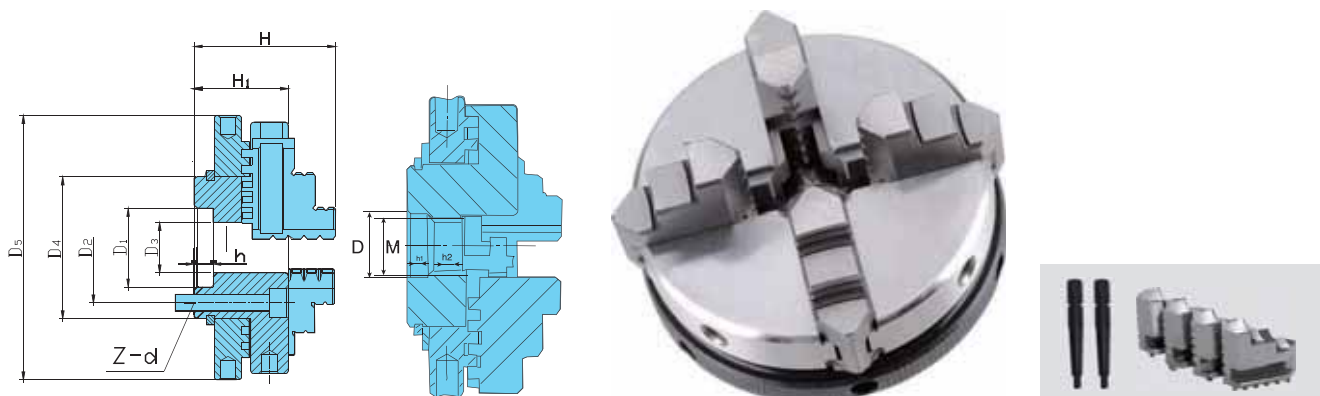

Code	Size	D	D1	D2	D3	D4	D5	H	H1	h	h1	h2	Z-d	M	Clamping Range	Jamming Range	N.W. (kg)
92814	CTB4-150	15			15	30	52	47	33	6	6	12		M14x1	1-33	16-50	
92815	CTB4-163	15	22	28	14	36	68	42	28	6	6	12	3-M4	M14x1	1-50	16-50	0.5
00000	CTB4-180	16.1	25	35	16	45	84	42	30	6	5	9.5	3-M5	M16x1	1.5-70	20-70	1.5
00000	CTB4-200	24.1	32	42	22	52	104	52	36.5	6	5	13.5	3-M6	M24x1.5	2-90	26-90	2

COLLET INDEX

FNL100B Horizontal Vertical Collet Index

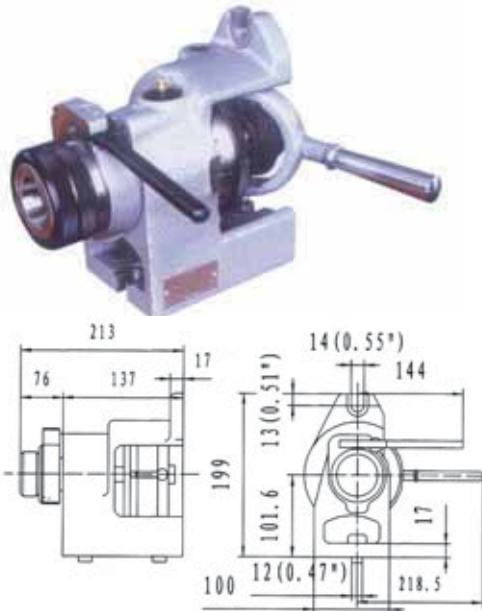

Specification

Code	00-0000-000
Items	FNL100B
Center height (mm)	101.6
Min. ID of spindle (mm)	∅ 31.75
Divisions	2.3.4.6.8.12.24
Spindle screw	2 1/4x8
Collet	5C
Dividing accuracy: individual spacing error	±3'
Net weight (Kg)	12
Gross weight (Kg)	15
Case dimensions (mm)	284x250x260

Type F1-5C Index

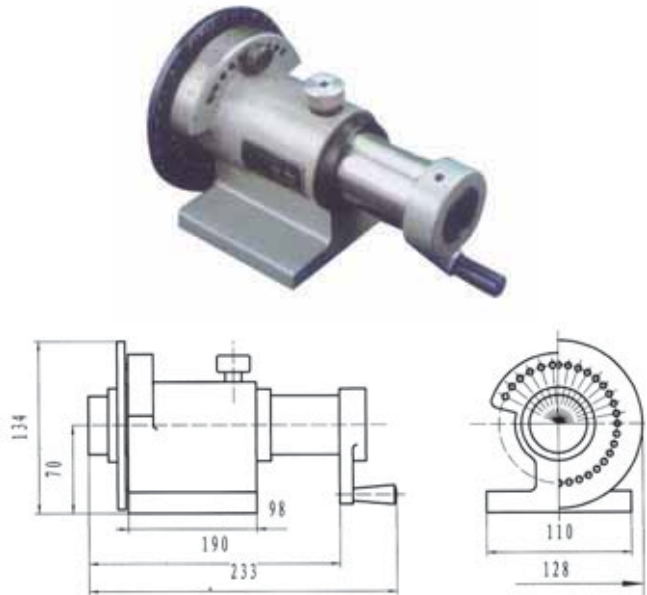

Specification

Code	00-0000-000
Items	F1-5C
Center height (mm)	70
Min. ID of spindle (mm)	∅ 31.75
Divisions	2.3.4.6.9.12.18.36
Min. dividing angle	1°
Min. graduated value	5°
Collet	5C
Dividing accuracy: individual spacing error	±4'
Net weight (Kg)	7
Gross weight (Kg)	8
Case dimensions (mm)	284x184x193

Micrometer Stand



Model	MS-102
Code	00-0000-000
Weight	0.2Kg

MAGNETIC BASE

Magnetic Stands



EMB-B 820N1



EMB-BV 820N1

Model		EMB-B 820N1	EMB-BV 820N1
Code		66814	66815
Holding Power (kg)		60	60
Main Body (mm)	Length	60	60
	Width	50	50
	Height	55	55
Main Stem (mm)	Length	176	176
	Diameter	Φ12	Φ12
Assistant Stem(mm)	Length	165	150
	Diameter	Φ10	Φ10
Diameter of Hole (mm)		4.5/8.0 + 0.02	
Weight (kg)		1.5	1.6

Extra Stem Magnetic Stands



WH-101



WH-106

Model		WH-101	WH-106
Code		000000	000000
Holding Power (kg)		60	60
Main Body (mm)	Length	60	60
	Width	50	50
	Height	55	55
Main Stem Length (mm)		280	280
Diameter of Hole (mm)	Slot	6.5	6.5
	Diameter	8.0+0.02	8.0+0.02
Weight (kg)		1.5Kg	1.5Kg

Extra Stem Magnetic Stands



MB-107



MB-108



MB-112



MB-113

Model	Code	Holding Power(Kg)	Main body (mm)			Main Stem(mm)		Assistant Stem(mm)		Diameter of hole(mm)	Weight (Kg)
			Length	Width	Height	Length	Diameter	Length	Diameter		
MB-107	00000	60	60	50	55	225	Φ16	200/190	Φ12	M10×1.25	1.7
MB-112	00000	60	60	50	55	225	Φ16	200/190	Φ12		1.7
MB-108	00000	100	73	50	55	360	Φ20	200/220	Φ12		2.6
MB-113	00000	100	73	50	55	360	Φ20	200/220	Φ12		2.6

With Fine Adjustment



Magnetic V-Holder Triangle

KV-7K

Code:93592
Power:50kg
Size:70X60X72mm



Magnetic V-Holder Triangle

KV-12K

Code:93593
Power:60kg
Size:101X70X95mm

HARDNESS TESTER

Rockwell Hardness Tester



HR-150A Code:66792

Feature & Use

- * Manual testing process, no need for electric controlling
 - * It's steady and reliable for testing of curved surface
 - * Precision conforms to the Standards of GB/T 230.2, ISO 6508-2 and ASTM E18
- It's suitable to determine the Rockwell hardness of ferrous, non-ferrous metals and non-metal materials. It can be widely applied in the Rockwell hardness testing for heat treatment materials, such as quenching, hardening and tempering, etc.

Specifications

Measuring Range	20-88HRA, 20-100HRB, 20-70HRC				
Test Force	588.4	980.7	1471N(60	100	150kgf)
Max. Height of Test Piece	170mm				
Depth of Throat	135mm				
Min. Scale Value	0.5HR				
Dimensions	466x238x630mm				
Weight	approx. 65kg				

Main Accessories

Large Flat Anvil	1 pcs
Small Flat Anvil	1 pcs
V-Notch Anvil	1 pcs
Diamond Cone Penetrator	1 pcs
1/16" Steel Ball Penetrator	1 pcs
Rockwell Standardized Block	5 pcs

Rockwell Hardness Tester



HR-150B Code:

Feature & Use

- * High travel of test anvil in vertical direction and it is suitable for testing of large test piece
 - * Manual testing process, no need for electric controlling
 - * It's steady and reliable for testing of curved surface
 - * Precision conforms to the Standards of GB/T 230.2, ISO 6508-2 and ASTM E18
- It's suitable to determine the Rockwell hardness of ferrous, non-ferrous metals and non-metal materials. It can be widely applied in the Rockwell hardness testing for heat treatment materials, such as quenching, hardening and tempering, etc.

Specifications

Measuring Range	20-88HRA	20-100HRB	20-70HRC		
Test Force	588.4	980.7	1471N (60	100	150kgf)
Max. Height of Test Piece	400mm				
Depth of Throat	160mm				
Min. Scale Value	0.5HR				
Dimensions	548x326x1025mm				
Weight	approx. 140kg				

Main Accessories

Large Flat Anvil	1 pcs
Small Flat Anvil	1 pcs
V-Notch Anvil	1 pcs
Diamond Cone Penetrator	1 pcs
1/16" Steel Ball Penetrator	1 pcs
Rockwell Standardized Block	5 pcs

Digital Display Rockwell Hardness Tester



HRS-150

Code:

Feature & Use

- * Frictionless loading shaft, high precision testing force
- * After preliminary test force is applied, the handwheel will lock automatically. Automatic testing process, no human operating error
- * Precision conforms to the Standards of GB/T 230.2, ISO 6508-2 and ASTM E18

It is suitable to determine the Rockwell hardness of ferrous, non-ferrous metals and non-metal materials. It can be widely applied in the Rockwell hardness testing for heat treatment materials, such as quenching, hardening and tempering, etc.

Specifications

Measuring Range	20-88HRA	20-100HRB	20-70HRC
Test Force	588.4	980.7	1471N (60, 100, 150kgf)
Max. Height of Test Piece	170mm		
Depth of Throat	130mm		
Unit for Display	0.1HR		
Power Supply	220V AC or 110V AC, 50/60HZ		
Dimensions	500x250x700mm		
Weight	approx. 75kg		

Main Accessories

Large Flat Anvil	1 pcs
Small Flat Anvil	1 pcs
V-Notch Anvil	1 pcs
Diamond Cone Penetrator	1 pcs
1/16" Steel Ball Penetrator	1 pcs
Rockwell Standardized Block	5 pcs
Printer	1 pcs

Motor-Driven Rockwell Hardness Tester



200HRD-150

Code:

Feature & Use

- * Optimized mechanical frame, automatic testing process
- * It's steady and reliable for testing of curved surface
- * Precision conforms to the Standards of GB/T 230.2, ISO 6508-2 and ASTM E18

It's suitable to determine the Rockwell hardness of ferrous, non-ferrous metals and non-metal materials. It can be widely applied in the Rockwell hardness testing for heat treatment materials, such as quenching, hardening and tempering, etc.

Specifications

Measuring range	20-88HRA, 20-100HRB, 20-70HRC
Test force	588.4, 980.7, 1471N (60, 100, 150kgf)
Max. height of test piece	210mm
Depth of throat	165mm
Min. scale value	0.5HR
Power supply:	220V AC or 110V AC, 50 or 60Hz
Dimensions	522 x 220 x 729mm
Weight	approx. 98kg

Main Accessories

Large Flat Anvil	1 pcs
Small Flat Anvil	1 pcs
V-Notch Anvil	1 pcs
Diamond Cone Penetrator	1 pcs
1/16" Steel Ball Penetrator	1 pcs
Rockwell Standardized Block	5 pcs

